

# GRINGLEY CHURCHYARD GRAVESTONE RECORDING PROJECT

Thank you for checking out this latest version of our Project WIP (Work in Progress) document.

This will eventually be in 10 Sections A/J reflecting the Sectors into which we have schematically broken up the Churchyard. So far we have loosely completed Sectors A, B, C and G. Other are being worked upon.

The labelling of Stones by Sector and unique Number are reflected in Maps of each Sector - drafts are included but will somehow be "professionalised".

Surnames with locations will also eventually all be indexed.

All photographs will be reviewed before publication and some Stones will be re-photographed as necessary.

If you would like to get involved in this project - and it's the more the merrier - please contact any member of the Committee.

Currently we have two Sectors still awaiting allocation to an enthusiastic and systematic pair of workers.

ATH 25 Aug 2017

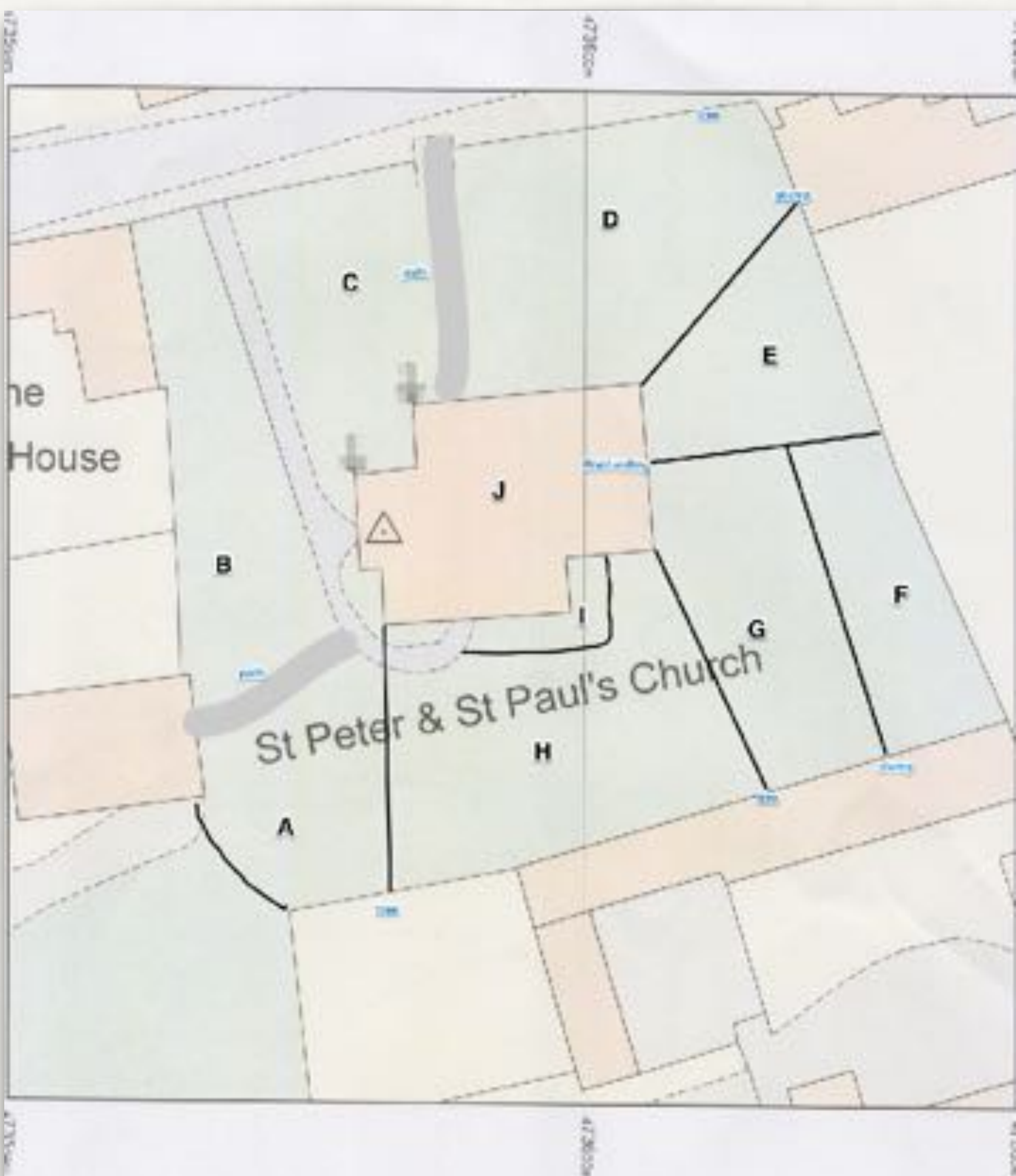

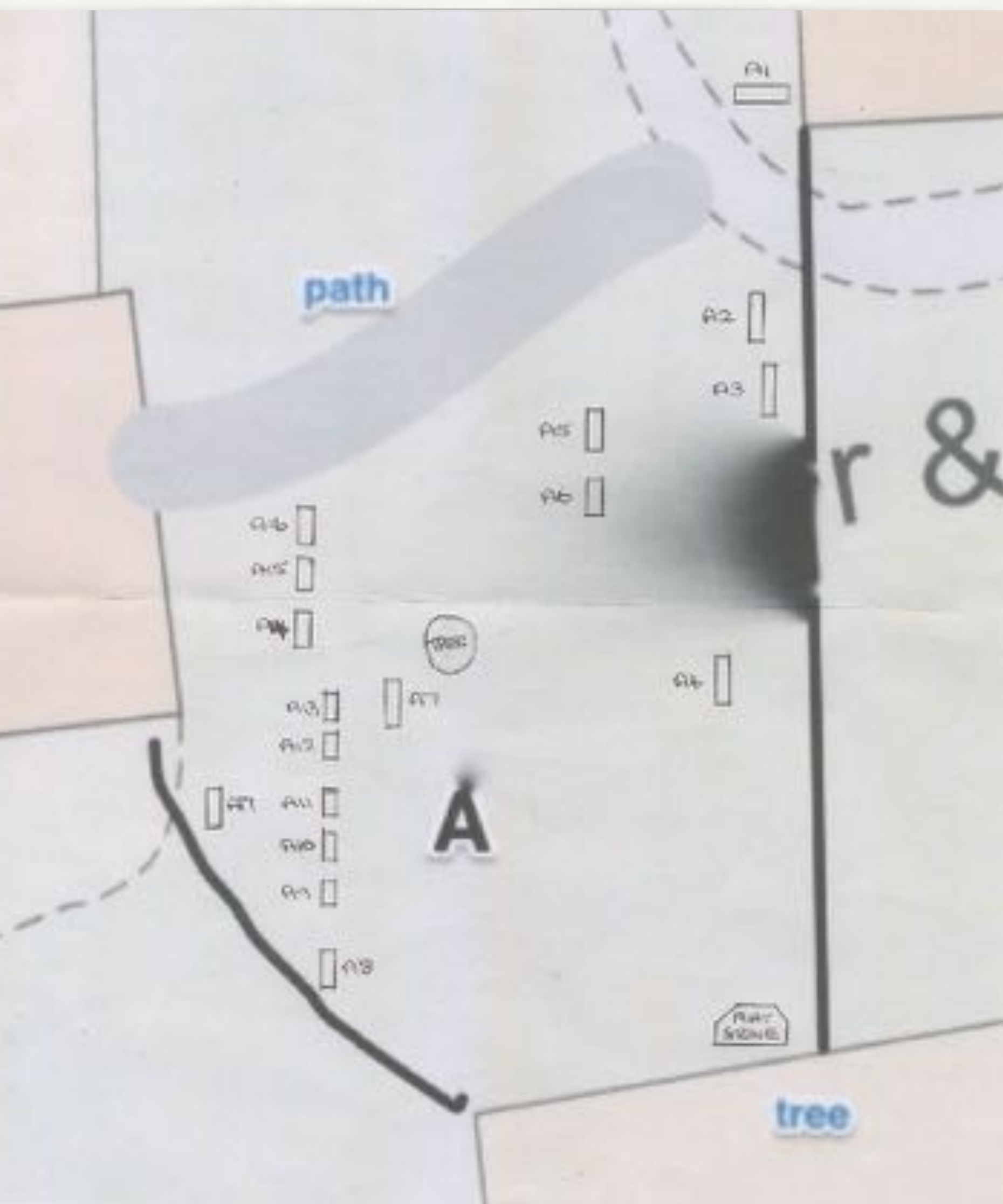



# A1

# INDECIPHERABLE

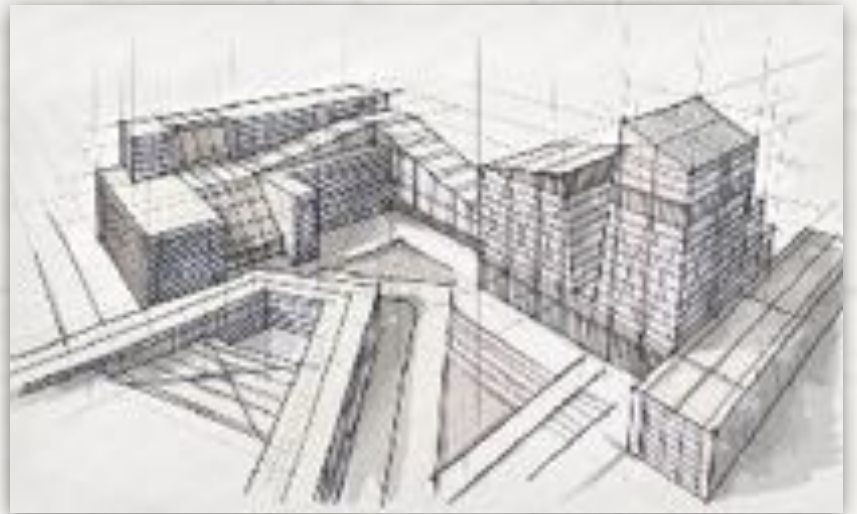

## ADDITIONAL NOTES

No inscription on top.

Partly worn date in Roman numerals on Eastern Edge ending VIII

Markings - probably a pattern rather than words on southern edge.

# A2

# ANCLIFFE

In Memory of ELIZABETH ANCLIFFE Wife of WILLIAM who died  
May 25th 1814 aged 58 years.

The weary lies at Rest.

Also WILLIAM ANTCLIFF Husband of the above who died May 11th  
1850. Aged 95 years.



## ADDITIONAL NOTES

Note the alternative spellings of the same name on the same  
Gravestone.



# A3

# BURKITT

In Memory of RICHARD BURKITT who died 4 May 1803 Aged 79 years.

Also ANN the wife of the above named RICHARD BURKITT who died 6 April 1806. Aged 91 years.

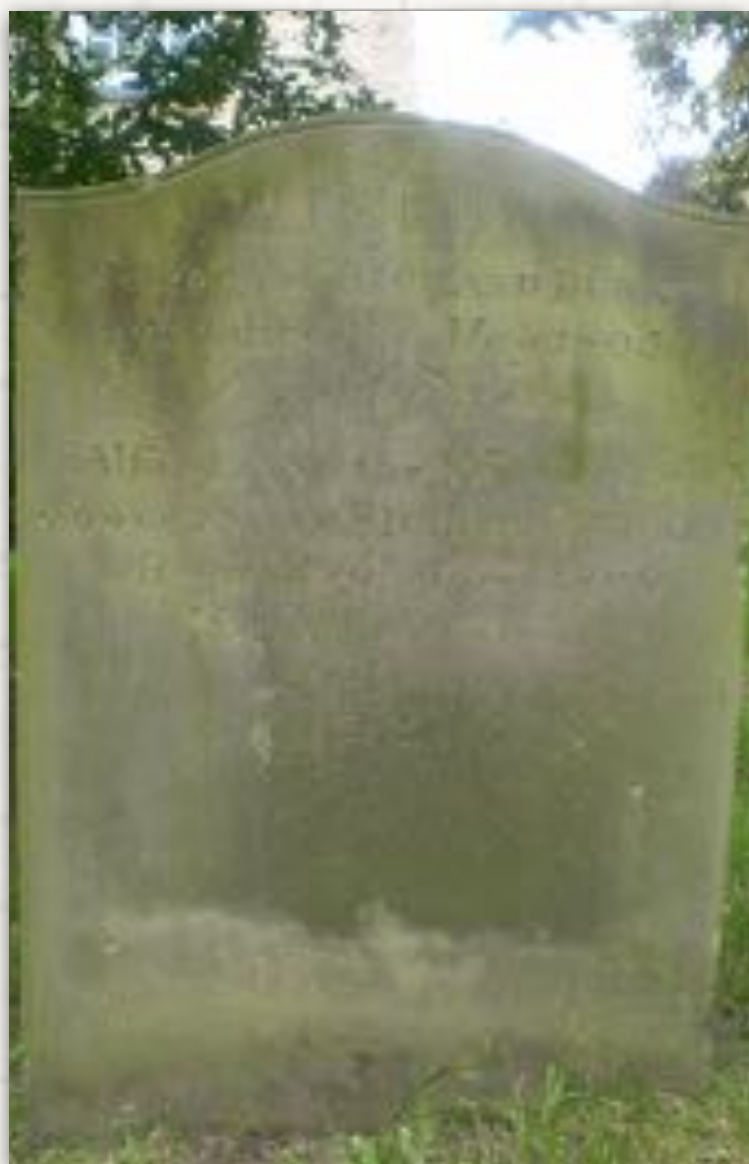

**ADDITIONAL NOTES**

# A4

# CLIFTON

In loving memory of JOHN the Beloved Husband of SARAH ANN CLIFTON

Died October 7th 1905

Aged 70 Years

The Will be Done



**ADDITIONAL NOTES**



# A5

# HILL

In Memoriam

WILLIAM HILL Born March 20th 1810

Died ?? 1876. ?? All in All

Also MARY his daughter who died in Infancy



## ADDITIONAL NOTES

Broken joint. Top part of memorial buried at the rear.



A6

# INDECIPHERABLE

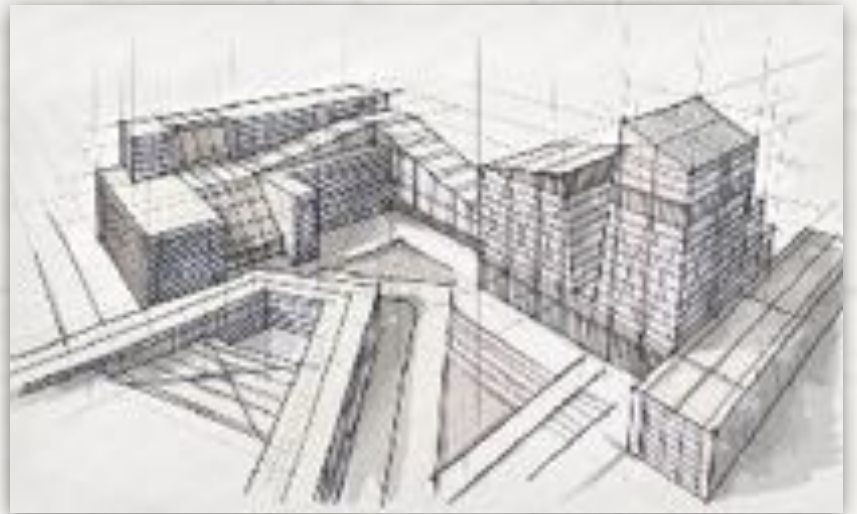

**ADDITIONAL NOTES**

# A7

# GABBITAS

Sacred to the Memory of ANN GABBITAS the Wife of George Gabbitas who departed this live on 8th day of March 1832. Aged 69 Years. (Quotation below).

Also of GEORGE GABBITAS who died Dec 9th 1848 Aged 86 Years



## ADDITIONAL NOTES

Quotation: "The sweet remembrance of the just shall flourish when they sleep in dust. We only leave a world of pain and depart to meet in Heaven again"

Sharpe Gringley



A8

# NETTLESHIP

JANE the Wife of JOHN NETTLESHIP died March 17th 1787  
Aged 57 Years.

Them which sleep in Jesus will God bring with him.



## ADDITIONAL NOTES



A9

MARRISON

In Loving Memory of HUTCHINSON MARRISON

Born April 4th 1847

Entered into Rest May 11th 1887

Until the day breaks and the shadows flee away



**ADDITIONAL NOTES**

# A10

# HUTCHINSON

In Memory of JOHN HUTCHINSON Born March V MDCCXCI (179?) Died July III MDCCCLVII (1857?)

In Memory of MARY relict of JOHN HUTCHINSON

Born June II MDCCXCIIII (1794?)

Died February II MDCCCLXXIX (1879?)



**ADDITIONAL NOTES**



# A11

# MARRISON?

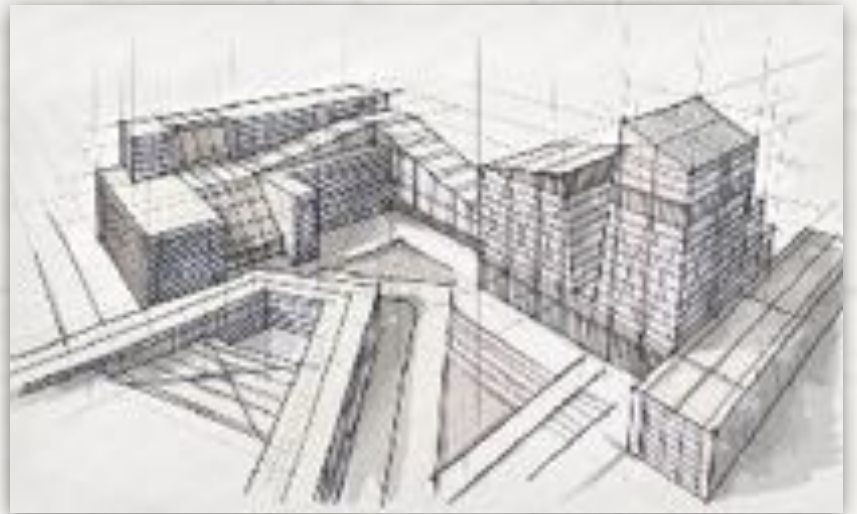

## **ADDITIONAL NOTES**

This stone is in very poor condition and probably pre-dates that of A10 (which was 1857). From the Burial Register it is possible this was Jonathan Marrison the older, died 1850,



# A12

# CRUMP

In affectionate Memory of HENRY CRUMP who departed this life April 17th 1861.

Aged 59 years,

Blessed are the dead which died in the lord.



**ADDITIONAL NOTES**



# A13

# CRUMP

In affection remembrance of ANN Wife of HENRY CRUMP  
who departed this life June 16th 1864.

Aged 64 years.

And now Lord what wait I for my hope in Thee.

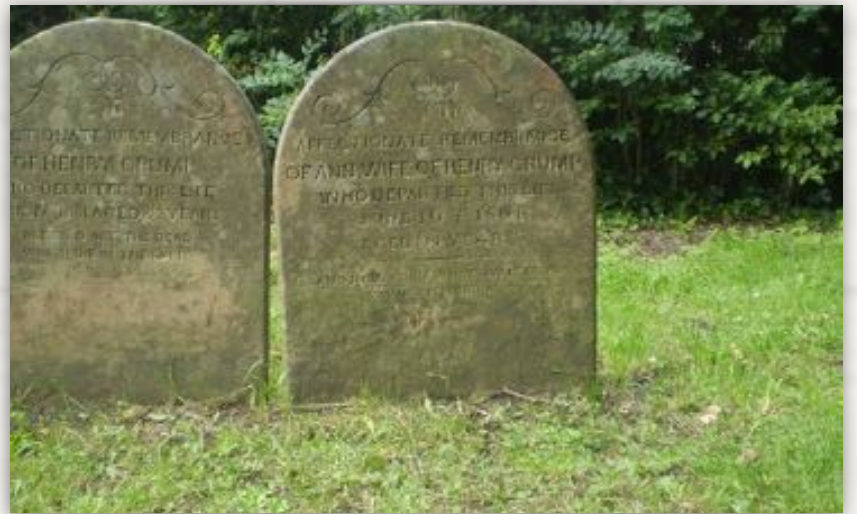

**ADDITIONAL NOTES**

# A14

# JOULE

In Loving Memory of THOMAS WALTER JOULE

Who died April 22nd 1906 Aged 51 Years

Thy Will be Done



**ADDITIONAL NOTES**



# A15

# DAVIDSON

In loving memory of CAROLINE DAVIDSON (Carrie) who died March 2nd 1891 Aged 19 years.

Also of LOUISA DAVIDSON (Louie) Sister of the above Sept 30th 1904 Aged. 27 Years



**ADDITIONAL NOTES**

# A16

# DAVIDSON

In loving memory of THOMAS DAVIDSON who died Dec 17  
1890 Aged 65 Years

Also of ANN DAVIDSON wife of the above who died Sept  
20th 1890. Aged 50 Years.



**ADDITIONAL NOTES**



A17

JOHNSON

Here lieth the Body of THOMAS JOHNSON .....???

Who departed this life 12th April 1841 in the 81st Year of.....

His Age



**ADDITIONAL NOTES**





# B1

# BAKER

In Loving Memory of WILLIAM LESLIE BAKER 3.5.1904 -  
11.10.1978 and FRANCES MARIE BAKER 8.11.1905-8.3.1993  
Peace, Perfect Peace



## ADDITIONAL NOTES

Inset marble plaque.

Still to be added to Census & Directories.



**B2**

**JENKINSON**

In Loving Memory of LUCY JENKINSON 24th February 2003  
Aged 84 Years



**ADDITIONAL NOTES**

Inset marble plaque.

Still to be added to Census & Directories.

# B3

# DURDY

The Memory of MARTHA DURDY who died June 22nd 1850  
Aged 42 Years. Indecipherable inscription follows.



## ADDITIONAL NOTES

Martha Durdy appears in the findmypast burial register as dying in 1850. She also features in the 1841 Census aged 34, living in Little Lane, married to William (33) an Agricultural Labourer. He is remarried to a Jane by 1851 and then we lose his trail. George is a son of Martha and William (born about 1834) and he is a farmer at Gringley Lock aged 37 by the 1871 Census.

Still to be added to Census & Directories.



# B4

# CARR

Left hand plaque: CHARLES CARR      He lived for those he  
loved, and those he loved remember.      1912-1985

Right hand plaque: PATRICIA CARR.      1909-1986      Loving  
Wife Mother and Grandmother



## **ADDITIONAL NOTES**

Inset adjacent plaques.

Still to be added to Census & Directories.

B5

THOMSON

DAVID MILLAR THOMSON MA PhD FRSA  
8.10.1928 - 24.9.2000



**ADDITIONAL NOTES**

Inset plaque.

Still to be added to Census & Directories.



# B6

# LEGARD

In Loving Memory of      MIKE LEGARD      21 Jan 1936 - 11  
May 2001      Loving husband father and brother      Gone but not  
forgotten



## ADDITIONAL NOTES

Inset marble plaque.

Still to be added to Census & Directories.



B7

ARKLESS

In Loving Memory Always In Our Hearts JAYNE ARKLESS  
27th April 1963 3rd May 2013



**ADDITIONAL NOTES**

Inset marble plaque.

Still to be added to Census & Directories.



B8

SEARLE

In Loving Memory of MICHAEL BERRETT SEARLE  
Died 10th Feb. 2002      Aged 74 Years      Sadly Missed



**ADDITIONAL NOTES**

Inset marble plaque.

Still to be added to Census & Directories.



B9

# CALLERY

Treasured Memories of MICHAEL CALLERY 5.2.39 - 12.6.01

Devoted husband dad and grandad Always in our thoughts



## ADDITIONAL NOTES

Inset marble plaque.

Still to be added to Census & Directories.



# B10

# CARTER

In memory of the Children of WILLIAM & ANNIE CARTER  
of this Parish who died 1855

Balance indecipherable and partially sunk below surface



## ADDITIONAL NOTES

See also William Carter himself B11. Four Carter deaths are recorded in the Findmypast Burial Register for 1855: Eliza Anne, George Isaac, Rosamund and Sarah Jane. William and Ann appear in the 1851 Census on Page 7 with children Rosamund (5), George (4), Charles (3), Eliza (2) and Ellen (10m).

# B11

# CARTER

In Loving Memory of Our Dear Father WILLIAM CARTER  
Born 20th October 1817      Died 2nd (June?/July?) 1901



## **ADDITIONAL NOTES**

Gravestone has at some point sheared horizontally and the top has been replaced in the earth below original base.

William Carter is confirmed in both Findmypast Index and Gringley burial register as having died 1901. See also B10 for the deaths of 4 children. The Gringley church burial register records Ann's death at 82 in 1904. William was a Tinman and Brazier and appears in several of our Directories and Census returns.



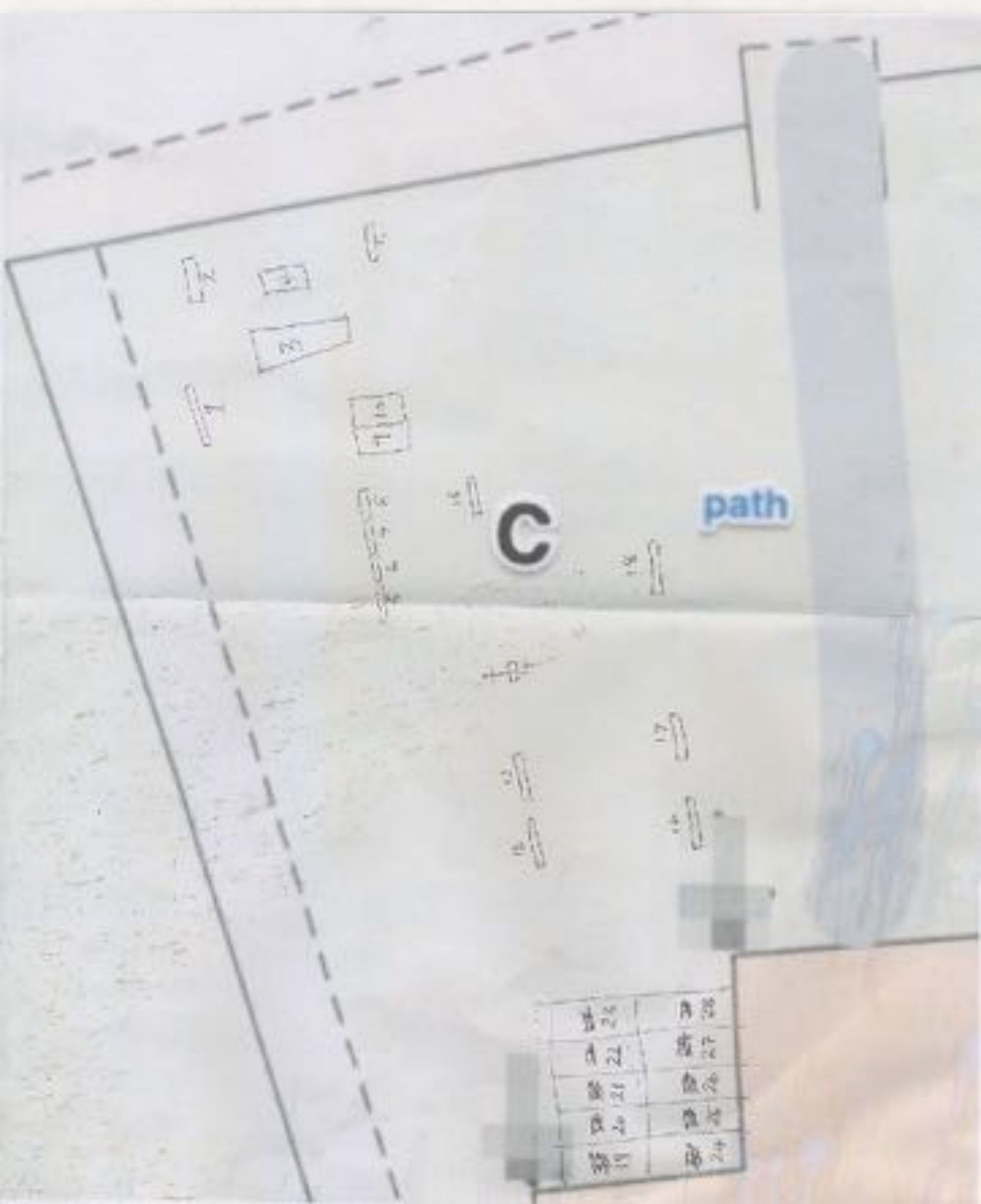

# C1

# ROBERTS

To the Memory of ROBT CLARK ROBERTS Who Departed this Life July 11th 1858 69 Years

Also HANNAH (Daughter?) of ROBT & ELIZh ROBERTS  
Died June 22nd 1872 Aged 52 years



## ADDITIONAL NOTES

Robert Roberts also appears in Trade Directories 1844, 1853 and 1862 described as a Maltster, and this occupation is also shown in the 1841 and 1851 Census. Residence was High Street in 1841.



# C2

# ROBERTS

In memory of MARIA the Wife of JOHN ROBERTS who  
Departed this Life Sepr 5th 1858 aged 35 Years.

Also two Children died young.



## ADDITIONAL NOTES

Maria - still not on Census & Directories.

John Roberts was the son of Robert (next door gravestone) born c. 1820. He is not recorded in any Trade Directory but appears as a Butcher on High Street in 1841, 1851 and 1871, but as an Agricultural Labourer in Green Lane in 1861 (when he is first shown as a widower).



# C3

# GAMSON

Southern Edge: To the Memory ROBERT GAMSON of Gringley Grange  
Died Feb VII (7th)

Eastern Edge: MDCCCLIV (1854) aged LXXIV years (74)

Northern Edge: Also of JANE his Wife Died January XXIII (23rd)  
MDCCCXLIX (1849)

Western Edge: Aged LXIX Years (69)



## ADDITIONAL NOTES

Robert was a prominent farmer indeed living at Gringley Grange (290 acres in 1851). In the 1841 Census he is shown as living with Ann aged 55, either a first wife or sister, with younger William and Martha both aged 25.



C4

INDECIPHERABLE



**ADDITIONAL NOTES**

# C5

# BOWS

In Loving Memory of WILLIAM BOWS who Departed this Life  
January 22nd 1881 aged 63 Years.

Blessed are the Dead which die in the Lord.



## **ADDITIONAL NOTES**

William was a stonemason and bricklayer, born in Blyton, first appearing in the 1841 census living in Horsewells, later after marrying Mary and having daughter Anne residing in Top Street & High Street. He was probably the Bows involved in building the National School. The name William Bows is still shown in an 1881 Trade directory, but also an 1885 one, 4 years after his death. Another William Bows is a bricklayer aged 20 in 1901 but there is no obvious family connection.



C6

INDECIPHERABLE

....1875



**ADDITIONAL NOTES**

# C7

# ANTCLIFFE

In Affectionate Remembrance of WILLIAM ANTCLIFFE of Gringley Lock who died August 21st 1864 aged 77 Years.

To depart and to be with Christ which is far better Phillipians 1.23



## ADDITIONAL NOTES

This William Antcliffe (born 1787) was at first a brick-layer, and is one of at least 2 of this same name also married to a Mary. There were at least 5 other Wiliams in our records. One other William Antcliffe (born 1755), presumably the father, preceded him as Lock-keeper, while his son (born 1819) continued the lock-keeper tradition.



C8

# ANTCLIFFE

In Loving Memory of MARY, Wife of WILLIAM ANTCLIFFE  
who Departed this Life September 21st 1871 aged 80 Years.

Her End was Peace.



## ADDITIONAL NOTES

This Mary Antcliffe was almost certainly the wife of the William buried next door to her.

Still not on the Census & Directories.

# C9

# BEMROSE

In Memory of JOSEPH BEMROSE Who Died November 6th  
1858 Aged (?)1 Years.



## ADDITIONAL NOTES

Joseph Bemrose makes one Gringley appearance in the 1851 Census as a 34 year old shopkeeper, married to Jane, and with daughter Emma aged 2.



# C10

# BEMROSE

In Memory of JANE Widow of JOSEPH BEMROSE  
Died 5th May 1883 Aged 66



## ADDITIONAL NOTES

Jane first appears in the 1851 Census, married to Joseph, now buried next door, and whom she outlives 25 years. She appears in 3 more subsequent Census returns and several directories shown as a Grocer, Draper or Chemist / Druggist, or some combination of these. She was based in Top Street / High Street. There was a son Joseph born c.1846 and three daughters. The girls stay with her and Emma marries George Lill who is also shown as a Druggist in the same property in 1881. Their son is destined to die in the Great War and appear on our War Memorial.

# C11

# REVILL

In Memory of GEORGE Son of WILLm & ELIZA REVILL who Died August 16th 1852 aged 7 Years. JOHN REVILL Son of the Above who Died September 28th 1852 Aged 9 Years. Also ARTHUR their Son Died October 3rd 1852 Aged 2,8,9  
???? Just gone to show how sweet such flowers in paradise would bloom



## ADDITIONAL NOTES

These 3 children of William and Eliza died within 7 weeks of each other in 1852. In the 1851 Census William (born Willingham, Lincolnshire c. 1817) is shown as Innkeeper and Butcher but not at which pub. In 1841 he had been an Ag Lab unmarried in Willingham. He and Eliza have left Gringley by 1861 and 1871, and are in Ferrybridge with more offspring. This is true for 1881 too, but sadly William by 1891 is an inmate widower in the Pontefract Union Workhouse. Another Revill family (Charles and Mary) remained in Little Lane. No evidence either way if the two are related.



# C12

# BROWN

BORSI ? BROWN

Who departed this life August ??

Also of MARY the wife of the above

GEORGE BROWN who departed this life 14 ? 1815



**ADDITIONAL NOTES**

# C13

# SMITH

In Memory of MARY  
Wife of JOHN SMITH  
Who departed this life Feby  
Rest Indecipherable



## ADDITIONAL NOTES

Berry was the apparent maker of the Stone - whose name survives the weathering where his handiwork has not.



# C14

# DRAKES

In Loving Memory of LIEUT PERCY WILLIAM DRAKES who died from his wounds in France Sept 16th 1916 Aged 32 years

And of his sister HILDA MARGARET DRAKES who died Jan 5th 1902 aged 10 years

R.I.P.



## ADDITIONAL NOTES

Metal letters on an upright memorial added after Graveyard was officially closed to new burials.

This individual is also recorded on the Gringley War Memorial and features in "Gringley: A Tribute to the 24" (published 2014). He was the son of the man who farmed at Manor House.

Foster Gainsborough

# C15

# METCALFE

In loving memory of JOHN METCALFE who died Oct 22nd 1880 aged 79 years.

Also of ANN wife of the above who died May 26th 1863 aged 60 years



## ADDITIONAL NOTES

The Metcalfes were a prominent family in Gringley in the 19th and 20th Centuries.

Foster was the apparent maker of the stone (bottom left hand corner)



# C16

# BRIGGS

Sacred to the Memory of WILLIAM BRIGGS who died Sept 26th 1824 aged 75 years.

He possessed all the virtues of a Christian.

Also JANE wife of the above who died December 20th 1846 aged 92 years.

She was a faithful wife, an industrious and an affectionate mother.

Also JANE their beloved daughter who died June 10th 1829 at Lady Key's Coleby Hall near Lincoln aged 50 years



## ADDITIONAL NOTES

Quotation at the foot of the stone:

Thou bright morning star by filial affections will never be excel'd

Great satisfaction in her situation she gave to Miss Nevile and Lady Key's as Housekeeper for 23 years.

# C17

# GELL

In Affectionate Remembrance of  
JACOB GELL who died Jan 11th 1900 aged 61 Years  
Thy Will be Done



**ADDITIONAL NOTES**



# C18 COOPER

In memory of MARY COOPER who died Sept 7th 1861 aged 52 years.

“Dear Husband though my life is past  
My love to you as long did last  
Then pray for me no sorrow take  
But love my children for my sake.”



## ADDITIONAL NOTES

# C19

# GAMSON

Sacred to the Memory of JAMES ? GAMSON

Who departed this life Oct... 18...?

Aged ??? Years



## **ADDITIONAL NOTES**

There are 10 GAMSON flat slabs or Tombs laid out as shown in the bottom right hand corner photograph.

This particular slab is on the Top row (right hand of the photo looking towards the Church) nearest to the Church and part obscured by the large Stone Coffin.



# C20

# GAMSON

Sacred to the Memory of SARAH GAMSON

Who departed this life March 23 1815 Aged 91 years.

God is Lord.



## ADDITIONAL NOTES

There are 10 GAMSON flat slabs or Tombs laid out as shown in the bottom right hand corner photograph. This particular slab is on the Top row (right hand of the photo looking towards the Church) second nearest to the Church.

# C21

# GAMSON

Sacred to the Memory of SARAH Daughter of JAMES & SARAH GAMSON

Who departed this life Dec the 26th 1855 Aged 78 years.



## ADDITIONAL NOTES

There are 10 GAMSON flat slabs or Tombs laid out as shown in the bottom right hand corner photograph. This particular slab is in the middle of the Top row (right hand of the photo looking towards the Church)



# C22

# GAMSON

Sacred to the Memory of GEORGE the son of JAMES & SARAH GAMSON

Died Jan 22nd 1858 Aged 69 Years.



## ADDITIONAL NOTES

There are 10 GAMSON flat slabs or Tombs laid out as shown in the bottom right hand corner photograph. This particular slab is on the Top row (right hand of the photo looking towards the Church) next to the furthest one from the Church.

# C23

# GAMSON

Sacred to the Memory of CHARLOTTE the Daughter of  
JAMES & SARAH GAMSON

Died Dec 21st 1883 Aged 92 Years



## ADDITIONAL NOTES

There are 10 GAMSON flat slabs or Tombs laid out as shown in the bottom right hand corner photograph. This particular slab is on the Top row (right hand of the photo looking towards the Church) furthest away from the Church.



# C24

# GAMSON

Sacred to the Memory of ?????? GAMSON

Departed this life 1821

....76 Years



## ADDITIONAL NOTES

There are 10 GAMSON flat slabs or Tombs laid out as shown in the bottom right hand corner photograph. This particular slab is on the Lower row (left hand of the photo looking towards the Church) and nearest to the Church but part obscured by the large Stone Coffin.

# C25

# GAMSON

Sacred to the Memory of CHARLES GAMSON Son of JAMES  
& SARAH GAMSON

Who departed this life August 5th 1827 Aged 12 Years



## ADDITIONAL NOTES

There are 10 GAMSON flat slabs or Tombs laid out as shown in the bottom right hand corner photograph. This particular slab is on the Lower row (left hand of the photo looking towards the Church) the second one along from the Church.



# C26

# GAMSON

Sacred to the Memory of MARY GAMSON

Who departed this life Sept 4th 1833 Aged 52 Years



## ADDITIONAL NOTES

There are 10 GAMSON flat slabs or Tombs laid out as shown in the bottom right hand corner photograph. This particular slab is in the middle on the Lower row (left hand of the photo looking towards the Church)

# C27

# GAMSON

Sacred to the Memory of HARRIET Daughter of JAMES & SARAH GAMSON

Died May 13th 1858 Aged 79 Years



## ADDITIONAL NOTES

There are 10 GAMSON flat slabs or Tombs laid out as shown in the bottom right hand corner photograph. This particular slab is on the Lower row (left hand of the photo looking towards the Church) and furthest but one from the Church.



# C28

# GAMSON

Sacred to the Memory of CAROLINE the Daughter of JAMES  
& SARAH GAMSON died Feb 15th 1883 Aged 87 Years



## ADDITIONAL NOTES

There are 10 GAMSON flat slabs or Tombs laid out as shown in the bottom right hand corner photograph. This particular slab is on the Lower row (left hand of the photo looking towards the Church) and furthest from the Church.

Roof valley



G

tree

stump



G1

A.R.



**ADDITIONAL NOTES**



**G2**

**G.E.R.**



**ADDITIONAL NOTES**



G3

E.R.



**ADDITIONAL NOTES**

# G4

# TINDALL

In Memory of SARAH the beloved Wife of WILLIAM  
TINDALL of Haxey Grange who died May 15th 1891 Aged 79  
Years

Be Ye Also Ready



**ADDITIONAL NOTES**



# G5

# BARROWCLIFF

CHARLES BARROWCLIFF

Died 1869



**ADDITIONAL NOTES**

# G6

# BARROWCLIFF

MARGARET ?

CHARLES BARROWCLIFF



**ADDITIONAL NOTES**



# G7

# ANTCLIFF

ANTCLIFF?

Indecipherable



**ADDITIONAL NOTES**

# G8

# MARSHALL

Ann Wife of THOMAS MARSHALL died 17th 1852 &  
THOMAS MARSHALL March 5th 1838

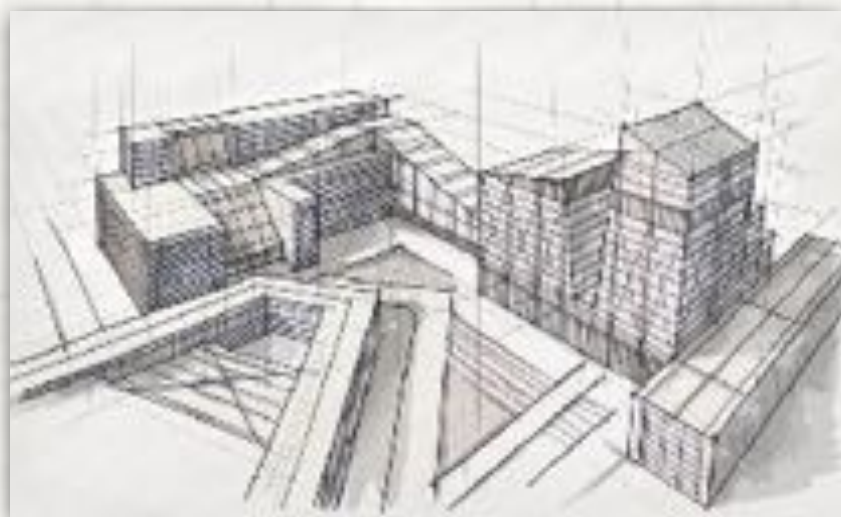

**ADDITIONAL NOTES**



# G9

# RILEY

In Affectionate Remembrance of ANN the Beloved Wife of  
GEORGE RILEY Who Died June 27 1897 72 Years

Thy Will be Done



**ADDITIONAL NOTES**

# G10

# NEWTON

GEORGE NEWTON Died Oct 13th 1850 51 Years

Also ELIZABETH Wife of the Above Who Died July 30th 1870  
Age 66 Years



**ADDITIONAL NOTES**



# G11

# SHELDON

THOs WILL SHELDON Son of WILLIAM & LUCY  
SHELDON Died Nov 21st 1888 Aged 9 Years



**ADDITIONAL NOTES**

G12

# INDECIPHERABLE

Indecipherable



**ADDITIONAL NOTES**



# G13

# LILLIMAN

WILLIAM SCOTT LILLIMAN Died Nov 12 1896 Aged 63  
Years



**ADDITIONAL NOTES**

# G14

# GREGG

JOHN GREGG Died April 26th 1821

ELIZABETH Died Nov 24 1824 Age 76?



**ADDITIONAL NOTES**



# G15

# BARROWCLIFF

MARGARET Daughter of RICHARD FINNINGLEY &  
HANNAH BARROWCLIFF of Upton Died May 24 1870 4  
Years Old



**ADDITIONAL NOTES**

# G16

# GREGG

THOMAS GREGG Died June 8th 1863 Aged 79 Years

SUSANNAH GREGG Died Jan 1846

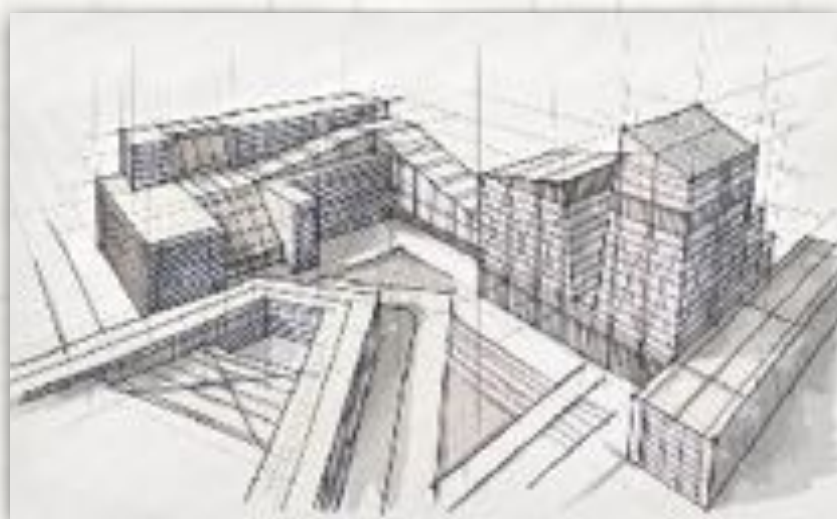

**ADDITIONAL NOTES**



# G17

# NEEDHAM

In Memory of MARY NEEDHAM Who Departed This Life Sep  
5th 1857 Aged 69 Years



**ADDITIONAL NOTES**

# G18

# NEEDHAM

In Memory of JAMES NEEDHAM Who Died July 29 1875  
Aged 79 Years

Blessed Are The Dead That Die in the Lord



**ADDITIONAL NOTES**



# G19

# NEEDHAM

In Loving Memory of GEORGE NEEDHAM May 30 1895  
Aged 65 Years

Also of JANE Beloved Wife of the Above Who died March 30th  
1895 Aged 60 Years



**ADDITIONAL NOTES**

# G20

# EMMINGHAM

ROBERT EMMINGHAM Oct 6 1905 66 Years



**ADDITIONAL NOTES**



# G21

# GRAHAM

WILLIAM GRAHAM & ????? GRAHAM

Wife 1844

WILLIAM GRAHAM 38 Years



## **ADDITIONAL NOTES**

Stone laid flat along the ground

# G22

# NEEDHAM

Affectionate Remembrance of ELIZA

The Wife of WILLIAM NEEDHAM Died Aug 7th 1877 Aged 45 Years

Her End Was Peace

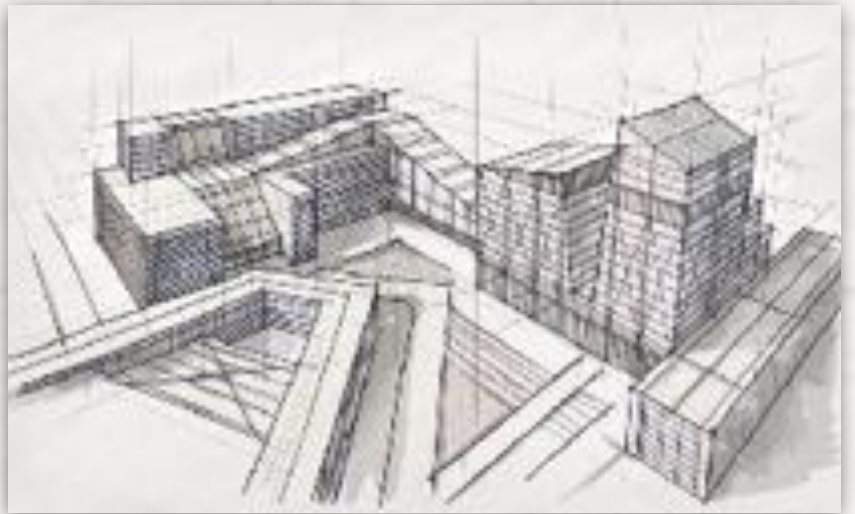

## ADDITIONAL NOTES

Stone flat to the ground



# G23

# NEEDHAM

In Affectionate Remembrance of WILLIAM NEEDHAM

Who Died Dec 28 1904 74 Years

His End Was Peace



**ADDITIONAL NOTES**

TITLE

TITLE TEXT



ADDITIONAL NOTES